

Biomass-fired Plants

[Solvay - Rheinberg](#)
[PowerCrop - Russi](#)
[Akuo Energy - CBN](#)
[JG Pears - Newark](#)
[Tilbury Green Power](#)
[Østkraft - Rønne](#)
[ENGIE - Biolacq Energies](#)
[ENGIE - BES VSG](#)
[ENGIE - SODC Orléans](#)
[Rothés CoRDe - Speyside](#)
[Zignago Power](#)
[ENGIE - BCN](#)
[Verdo Produktion - Randers](#)
[WWEP - Port Talbot](#)
[FunderMax - Neudörfel](#)
[Linz-Mitte](#)
[Boehringer Ingelheim](#)
[B.W. Schneider - Eberhardzell](#)
[Swiss Krono - Heiligengrabe](#)
[Pfleiderer - Gütersloh](#)
[EPR Glanford - Scunthorpe](#)
[Pfleiderer - Neumarkt](#)
[Egger - Pannovosges](#)

Service and O&M

[Swiss Krono - Heiligengrabe](#)

Aalborg Energie Teknik a/s Biomass Power Plant

Tilbury Green Power Plant, London, UK

The Tilbury Green Power project demonstrates The Irish utility company, ESB's continued commitment to renewable energy and further reducing their carbon footprint.

The plant owners, Electricity Supply Board (ESB), Green Investment Bank (GIB), BWSC and AET point out that the generated power is equivalent to powering approximately 70,000 homes.

Senior debt funding has been provided by the Danish Export Credit Agency (Eksport Kredit Fonden), Investec and Rabobank.

Reducing Waste in London City

The Tilbury Green Power (TGP) power plant, with a net electrical output of 40 MW_e, is fuelled with recycled waste wood e.g. from construction sites.

Due to the location close to London, directly by the River Thames, the power plant helps in reducing the amount of waste in the city. The plant consumes approx. 270,000 tonnes of waste wood per year, which is sourced from the local catchment area. The plant created approx. 370 jobs during the construction phase and approx. 50 permanent jobs in on-going operations.

Turnkey Delivery

AET and BWSC were responsible for construction and now for operation and maintenance of the biomass-fired power plant throughout a 20-year period.

The TGP plant commenced operations in 2017.

AET designed, supplied, constructed and commissioned the following scope:

- Fuel feeding and AET Fuel Dosing System
- [AET Combustion System](#) with AET Spreader Stoker and AET Biograte
- [AET Biomass Boiler](#) with superheaters and economisers
- AET Combustion Air System
- Oil burner
- [AET SNCR deNOx System](#)
- AET Steam Air Preheaters
- Feed water system
- Ash handling system
- Bag filter with lime and active carbon injection system
- Flue gas system and stack
- Piping and ducting
- Insulation
- Structural steel for boiler house
- Platforms and stairs
- Instrumentation
- PLC system and SCADA system for the full plant
- 20 years' operation & maintenance contract.

Additional Information

- UK Green Investment Bank and ESB support new £190m renewable electricity plant on the Thames: [Read more.](#)
- About Tilbury Green Power: [Read more.](#)
- To obtain more information about this biomass-fired plant and about AET: [Contact AET sales.](#)

Boiler: 125 MW_{th}
92 bara
477 °C
Electrical power: 40 MW_e



The construction of Tilbury Green Power plant.

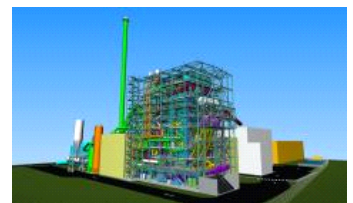

A 3D Illustration of the Tilbury Green Power plant.

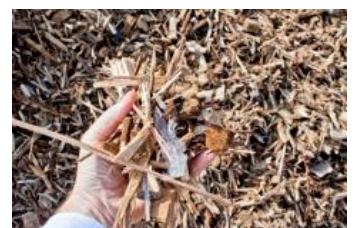

The Tilbury Green Power plant combusts waste wood.



The Biolacq Energies project, in Lacq, is a biomass-fired CHP plant of 54 MW, that utilises forestry wood, and clean, uncontaminated residues from wood processing.

[Read more about Biolacq](#)



Tilbury Green Power is a 125 MW waste wood-fired plant, which commenced operations in 2017.

[Read more about Tilbury Green Power](#)



JG Pears – Newark is a 42 MW MBM-fired cogeneration plant, which commenced operations in 2018.

[Read more about JG Pears - Newark](#)



Akuo Energy - CBN is a 63 MW wood-fired cogeneration plant, which commenced operations in early 2019.

[Read more about Akuo Energy - CBN](#)

FOCUS ON

[> Read full Focus](#) [> Go to Archive](#)

Zignago Power s.r.l.–successfully producing Green Energy in Italy

The 49 MW Zignago Biomass power plant in Italy, owned and managed by Zignago Power s.r.l., belonging to the Marzotto family empire, has since its installation in 2013 been running with a very high availability (98,8%). The plant utilises wood residues and agricultural waste such as straw, miscanthus and maize. [>Read more](#)

